

**WIRE SEALING GROMMET  
JOINT D'ETANCHEITE**

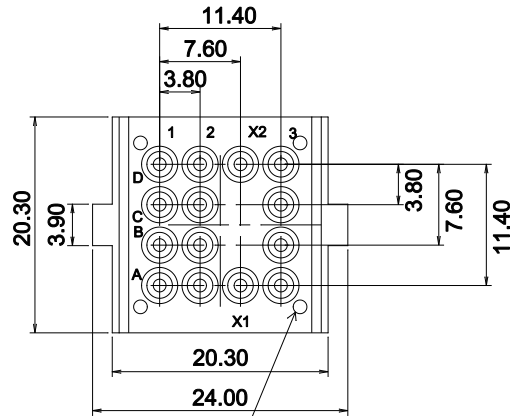

**MATING RELAY STOP POST  
PLOTS D'APPUI DU RELAIS**

**Applicable relays:**  
M220 (Track Mount)

**Qualified to:**  
MIL-DTL-12883/52-002

**Applicable track:**  
MT-3000-003

Dimensions in mm  
Tolerances, unless otherwise specified,  $\pm 0.12$ mm

**GENERAL CHARACTERISTICS  
CARACTERISTIQUES GENERALES**

<b>Weight</b> <i>Poids</i>	14g max.
<b>Used in conjunction with MT-3000-003</b> <i>Utilisé en union avec MT-3000-003</i>	
<b>Supplied with No. 20 contacts and No. 20 crimp.</b> <i>Livré avec contacts No. 20 et</i>	

LEACH INTERNATIONAL EUROPE S.A.S.  
Tel: +33 3 87 97 98 97  
Fax: +33 3 87 97 96 86

LEACH INTERNATIONAL ASIA PACIFIC  
Tel: +852 2 191 3830  
Fax: +852 2 389 5803

The technical information provided by Leach International Europe is to be used as a guide only, and is not meant for publication or as documentation for altering any existing specification. Dimensions are in millimeters unless otherwise specified. Rev. 06/2019.